



# 06

- Fruits tree pruning
- Landscaping
- Gardening

## PRUNING SAW series

Crafted for professional arborists, fruit growers and gardeners.

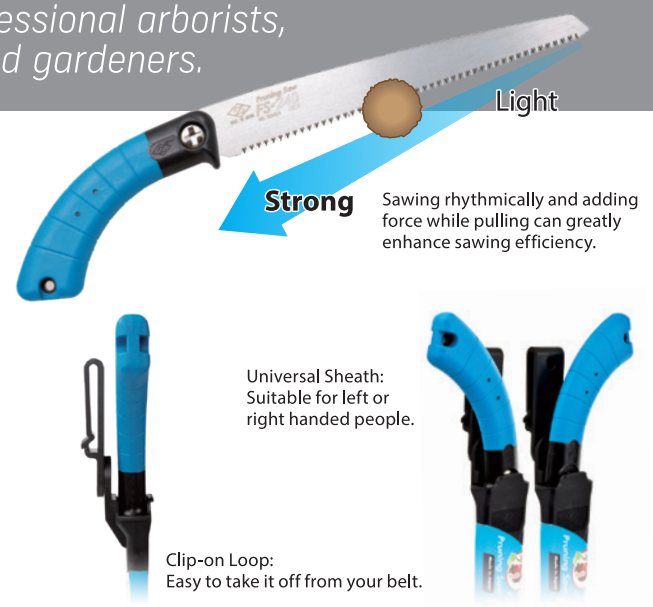

### Blade replacement

**Detachment**  
Loosen the screw with a coin or a screwdriver and pull the blade out from the handle.

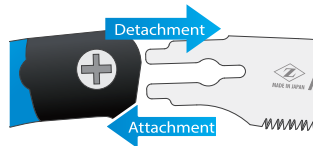

**Attachment**  
Insert the blade and tighten the screw to fix the blade firmly.

### Blade care

Please wrap the blade in VCI (Volatile Corrosion Inhibitor) paper or newspaper for storage.

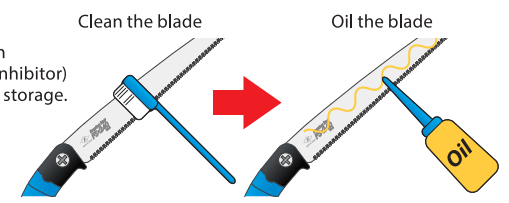

## FS-245 P3.5

- Forest
- Fruit
- Ni-P plated
- Impulse Hardening
- Screw fit

The firm blade and extremely sharp teeth make this saw ideal for fruit tree pruning and general gardening.



NO.	ITEM	BOX	CTN	SPEC	
52431	Saw	6	36	Blade Length	240mm
52432	Blade	24	-	Pitch	3.50mm
				Thickness	0.90mm

## FS-275 P3.5

This 270mm length blade featuring extremely aggressive sharp teeth makes this saw ideal for forest tree trimming and gardening.

- Forest
- Fruit
- Ni-P plated
- Impulse Hardening
- Screw fit



NO.	ITEM	BOX	CTN	SPEC	
52433	Saw	6	36	Blade Length	270mm
52434	Blade	24	-	Pitch	3.50mm
				Thickness	0.90mm

## FS-210 P3.0

Ideal for pruning apple, olive, plum and other fruit trees.

- Fruit
- Garden
- Ni-P plated
- Impulse Hardening
- Screw fit



NO.	ITEM	BOX	CTN	SPEC	
52421	Saw	6	36	Blade Length	210mm
52422	Blade	24	288	Pitch	3.00mm
				Thickness	0.70mm

## FS-240 P2.4

Ideal for pruning apple, pear and other fruit trees.

- Fruit
- Garden
- Ni-P plated
- Impulse Hardening
- Screw fit



NO.	ITEM	BOX	CTN	SPEC	
52423	Saw	6	36	Blade Length	240mm
52424	Blade	24	288	Pitch	2.40mm
				Thickness	0.70mm

## FS-270 P2.4

Ideal for pruning apple, peach and other fruit trees.

- Fruit
- Garden
- Ni-P plated
- Impulse Hardening
- Screw fit



NO.	ITEM	BOX	CTN	SPEC	
52425	Saw	6	36	Blade Length	270mm
52426	Blade	24	288	Pitch	2.40mm
				Thickness	0.70mm